

Hannibal Housing Authority Administrative Offices

Hannibal, Missouri

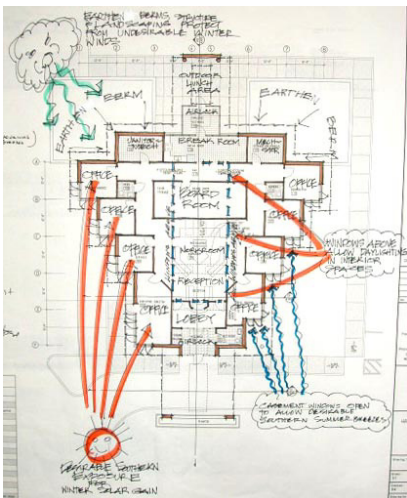

The entrance to the Hannibal Housing Authority Administrative Offices features a portico at the entrance to the office.



Offices, positioned on the exterior wall of the building, are stair-stepped to take advantage of the view, southern exposure and desirable winter solar gain.



The Hannibal Housing Authority Administrative Office Building includes many sustainable design practices.

A longtime client and friend, Jack McCord, Executive Director of the Hannibal Housing Authority, wanted PWA to design the Housing Authorities' new administrative offices. So the project could be adequately serviced during construction it was suggested that PWA associate with a local architect. PWA provided the design of the facility and the local firm provided the construction documents and construction administration.

The brick exterior of this 4,200 square foot office building features offices positioned on the exterior wall of the building, stair-stepped to take advantage of view, southern exposure and desirable winter solar gain. These offices, which include

operable windows to increase natural ventilation, surround the common areas of the building including the lobby, reception area, conference room, work room and board room.

To increase the energy-efficiency of the structure roof overhangs were calculated to allow the winter sun to heat and illuminate spaces, while shutting out undesirable summer exposure. Unoccupied spaces on the north side of the building such as the janitor's and mechanical storage rooms act as buffers against winter winds. A break room was also located on the north side adjacent to the outdoor patio to take advantage of summer shade.

